

BUDHA DAL PUBLIC SCHOOL PATIALA
FINAL TERM EXAMINATION (March 2025)

Subject-EVS
Class - I (Set- A)

Name: _____ **Roll No.** _____

Section : _____

Time: 2:30 hours

Maximum Marks:60

Section A Multiple Choice Questions

Choose the correct answer:

1. In which season should we drink a lot of water? **8 M**

- | | |
|-----------|-----------------|
| A) winter | B) rainy season |
| C) autumn | D) summer |

2. Which of the following may be found in some houses only?

- | | |
|---------|------------|
| A) roof | B) window |
| C) door | D) balcony |

3. Which of the following helps us boil and steam food?

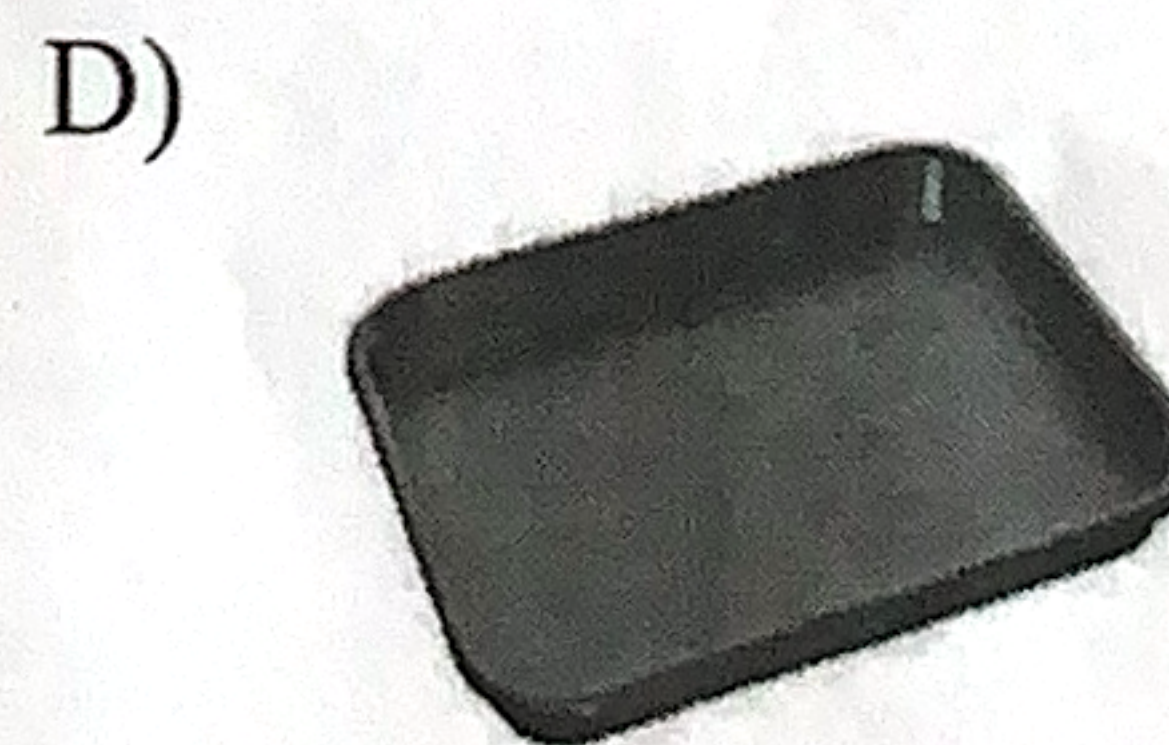
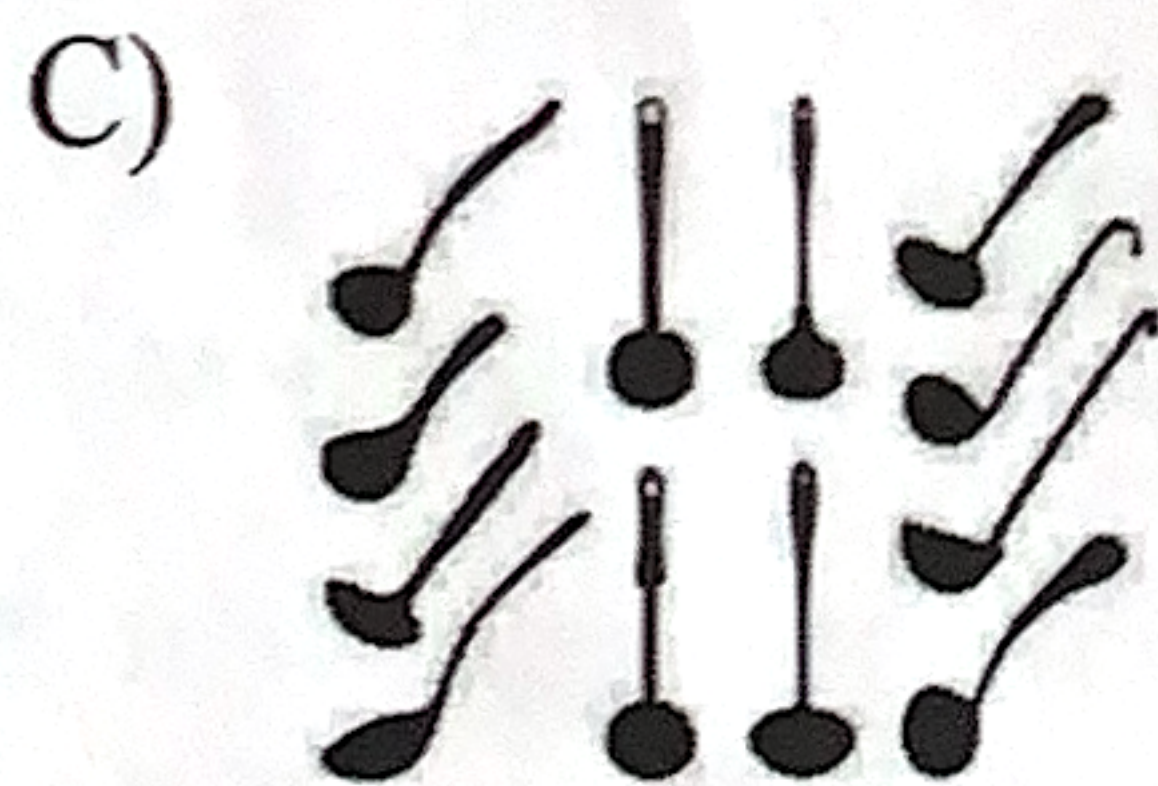

4. Which of the following do we use in winter?

A)



B)



C)



D)



5. Which of these is NOT a pet animal?

A) dog

B) cat

C) bear

D) rabbit

6. Which of these is food for small babies?

A) Fruits

B) eggs

C) Milk

D) vegetables

7. Mahira wants to serve food to her guests. Which of the following vessels should she use to serve food?



8. With whom do we live in our house?

A) Our family

B) Our teachers

B) Our friends

D) Our classmates

SECTION B

Very Short Answer Questions

6M

9. We eat ,sleep and play with our family in our
(school/house)

10. are different parts of the year. (Months/ Seasons)

11.The food that we eat is called raw food.

(cooked/ uncooked)

12. changes within a few hours.(Weather/Climate)

13. cannot be eaten raw. (Vegetables/ Grains)

14.Small babies do not have to chew. (teeth/ hands)

Answer the following questions in a word or a sentence

3 M

15. In which room of our house do we cook food?

16. How many rooms are there in a house?

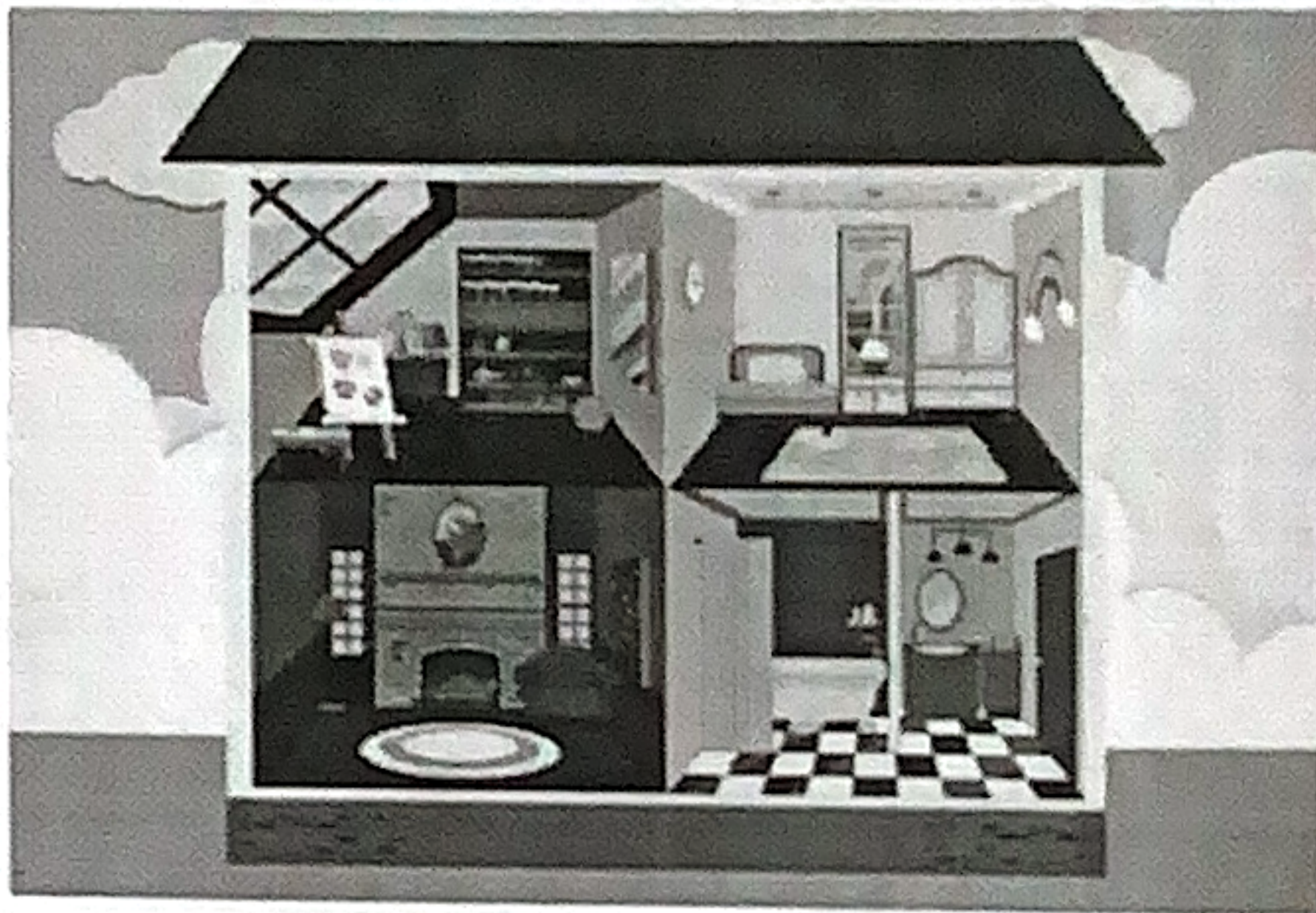

17. Write the name of a place, other than forests, where we can see some wild animals

Write Yes or No

6 M

18. There is snow fall in summer at some places. _____

19. A rabbit is a small animal. _____

20. It rains a lot during summers. _____

21. Old leaves turn yellow in autumn. _____

22. We take bath in the kitchen. _____

23. We have the same climate in all the seasons. _____

Name the following :

3 M

24. The room used for eating food

25. The weather of a place that stays for a long time

26. A small animal

27. Choose the correct words from the brackets and complete the chart. 2 marks
(kitchen , bathroom , bedroom , sleep, bath)

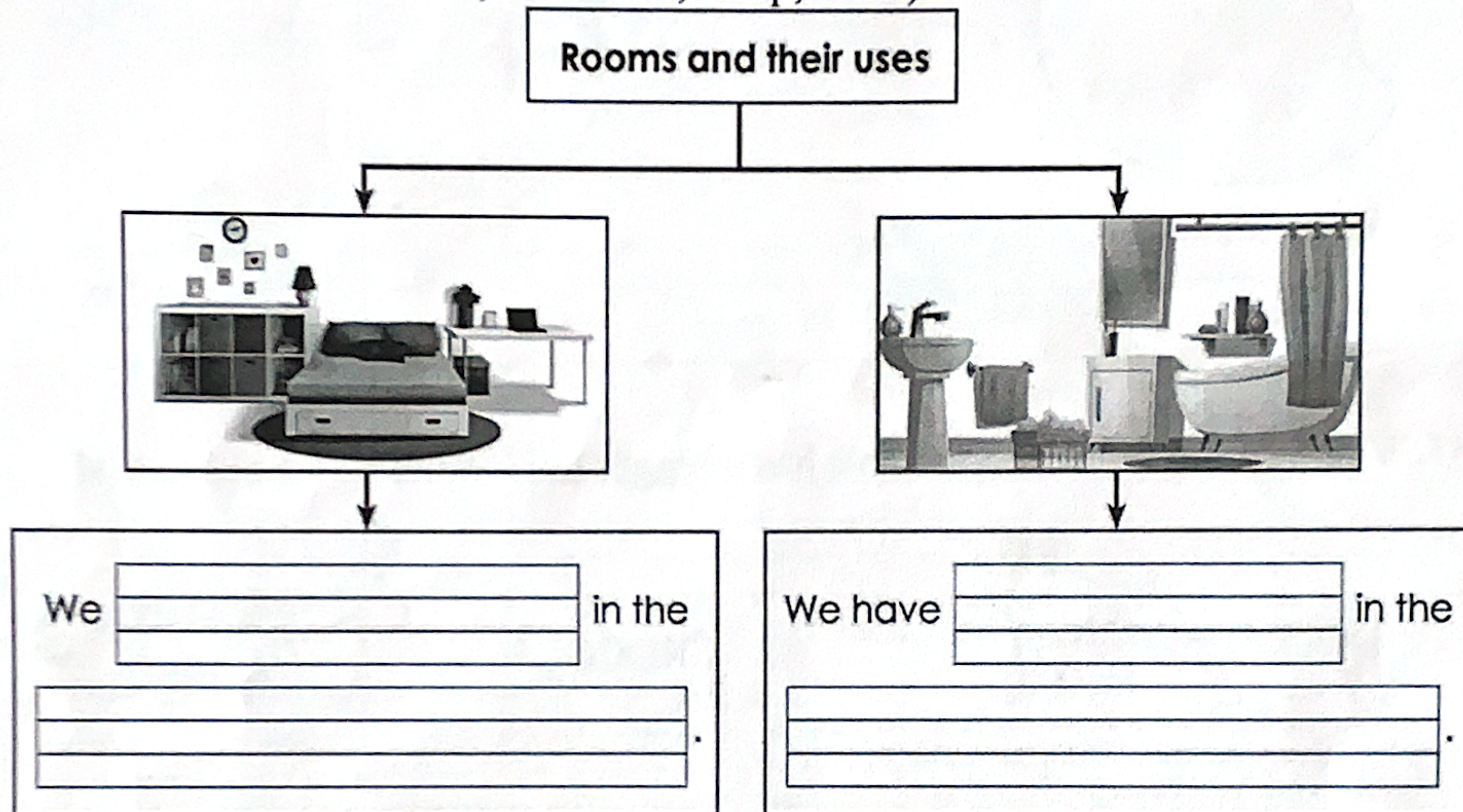

Section C

Short Answer Questions

32 marks

Answer the following questions in one or two sentences:

28. Write the names of two food items from the following that babies can eat.
(fruit pulp, juice, chapati) 2M

29. Write the names of any two animals that are not very active during the day. 2M

30. Which are the short seasons?

2M

31. Name the fruits shown in the picture and colour them.

2 M

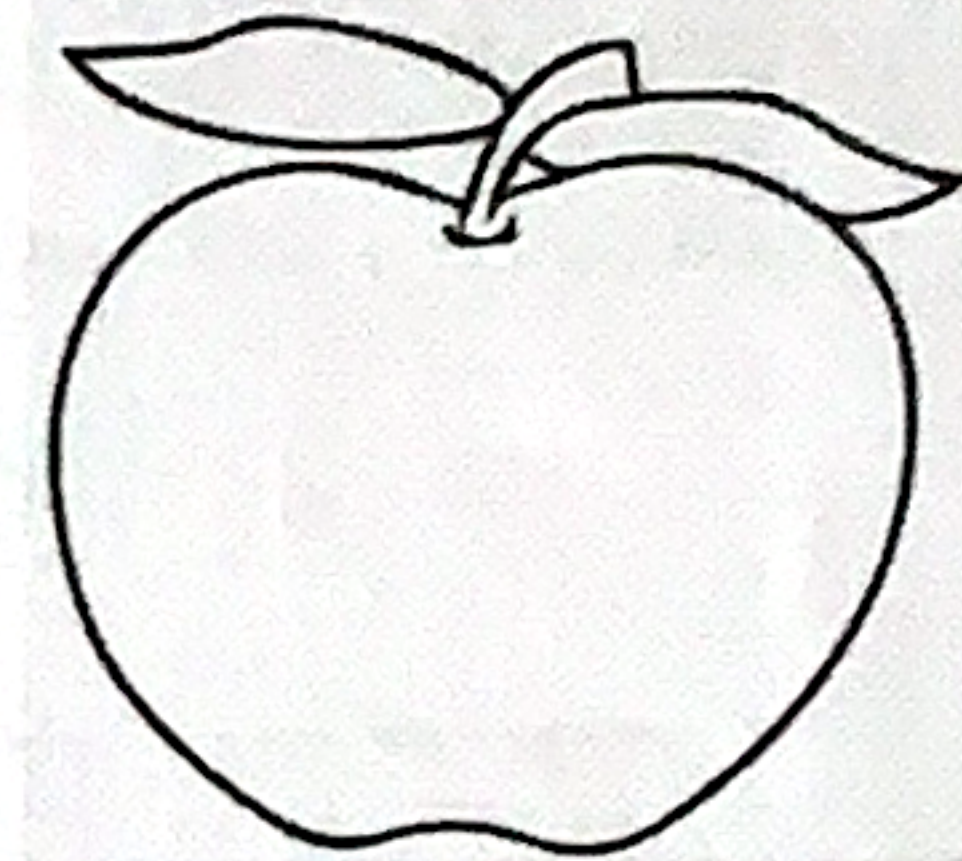
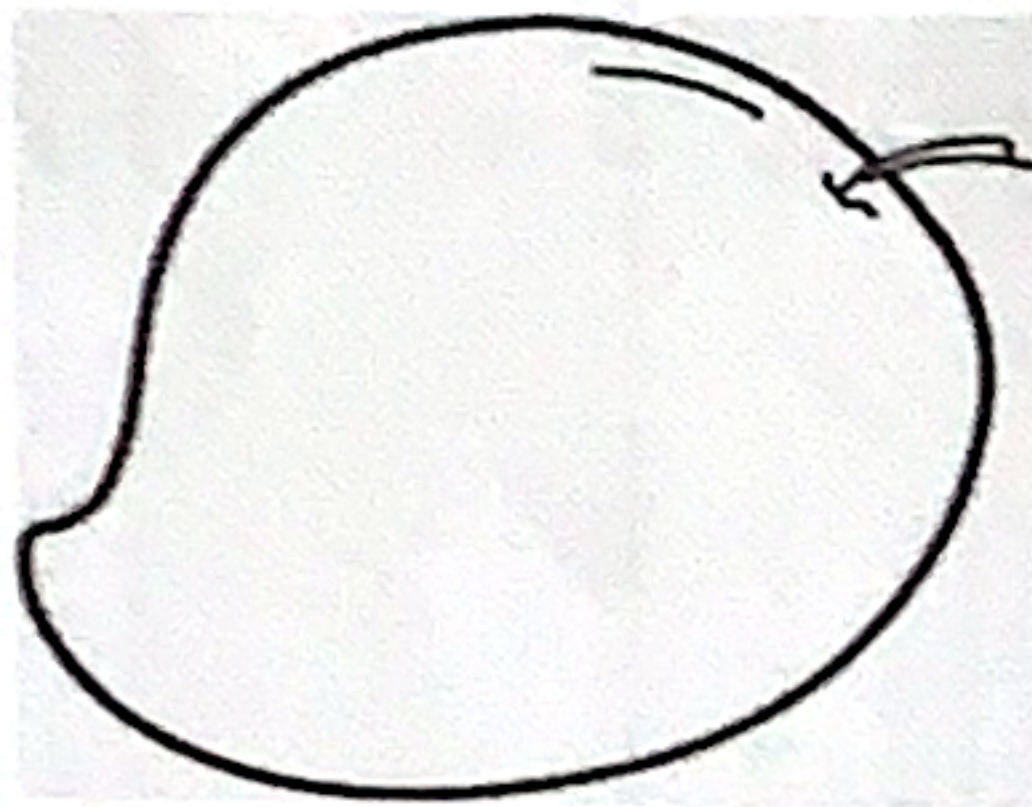

32. Which of the following animals has a bigger tail? Write its name.

1 M

DOG



CROCODILE

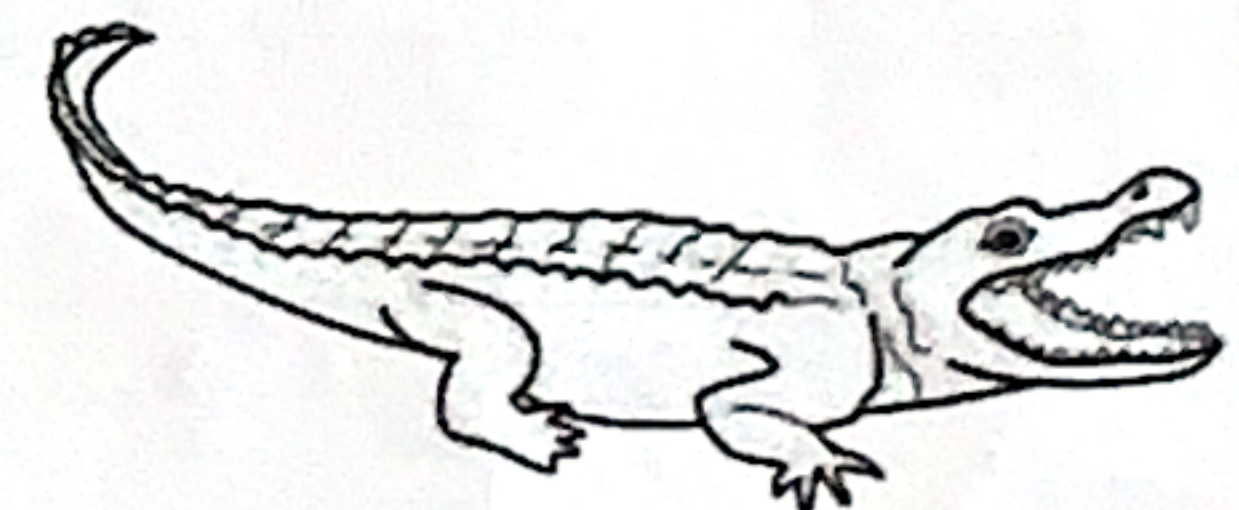

33. Where do animals such as fish and whale live?

1 M

34. Sweta has a beautiful garden. The trees in her garden are full of new leaves and colorful flowers. Can you guess the season.

1 M

35. Ridhi's doctor advised her to eat food items that would make her strong. Write any two food items that she should eat.

2 M

36. What is an igloo?

2 M

37. Identify the land animal and write its name.

1 M

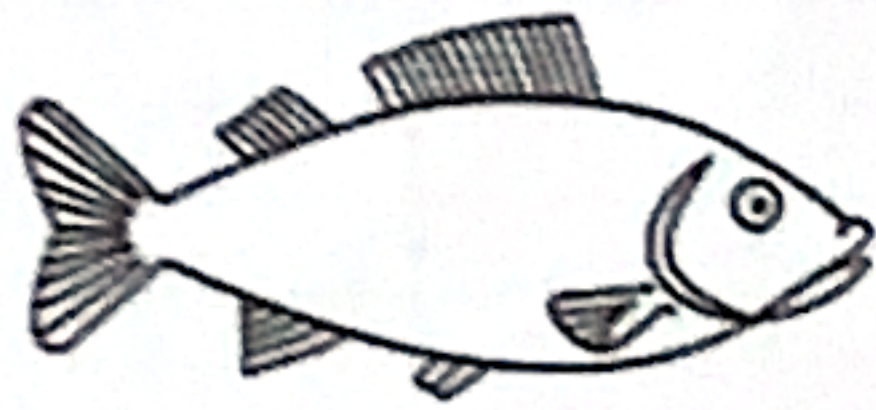

38. Name the room shown in the picture.

2 M



39. Label the following in the picture given below.

2M

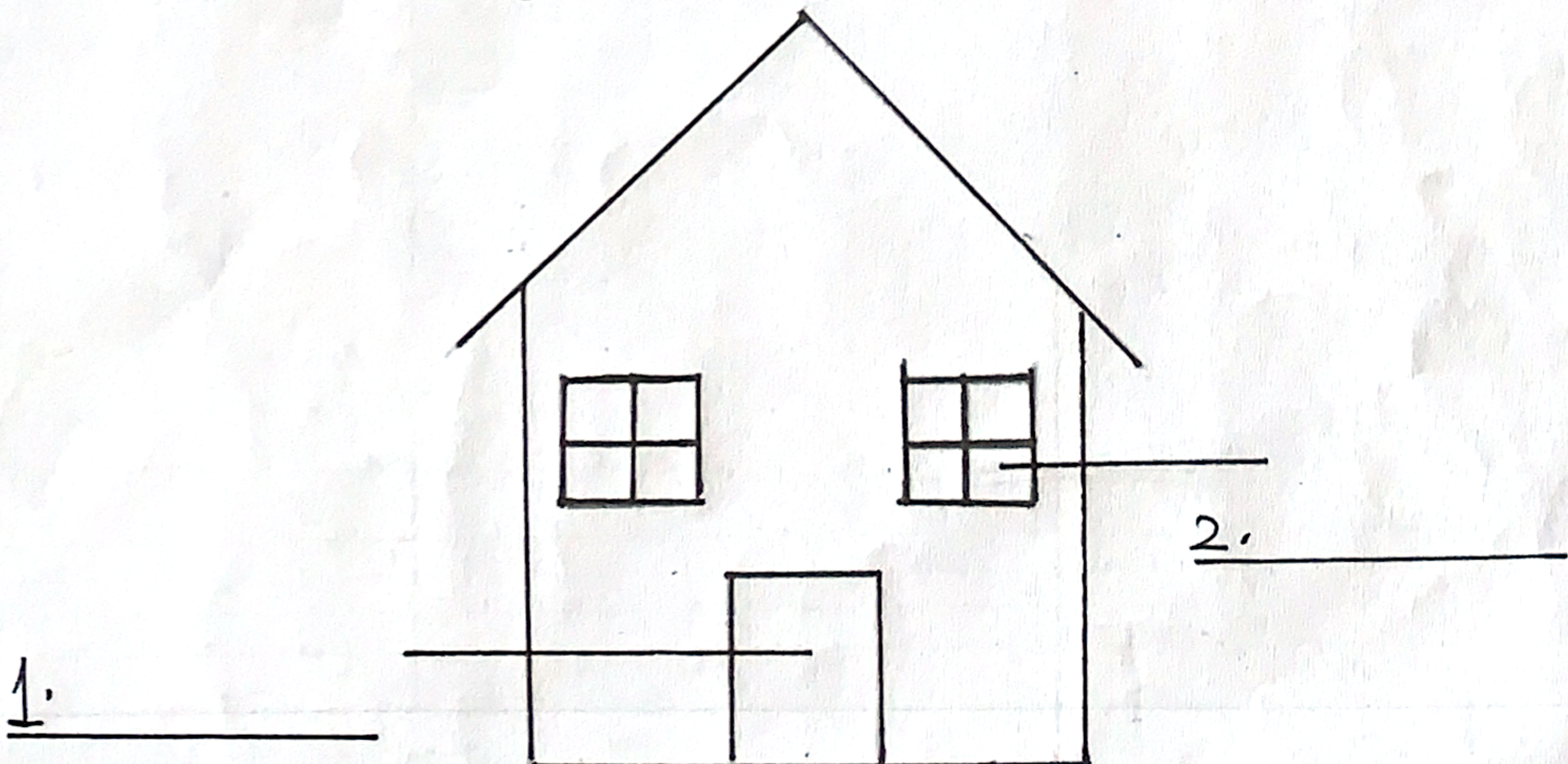

40. How does a clean house help us?

2 M

41. What are the animals that live on farms and fields called? Give one example? 2M

42. I help you to grow. I make your teeth and bones stronger. You must drink me every day. Who am I?

1 M

43. Name the two types of food.

2 M

44. Draw a picture of a thing that we carry when it rains. Write its name.

2 M

45. Choose the correct words from the brackets to complete the chart.

2 M

(Rainy, Summer, Winter, Spring)

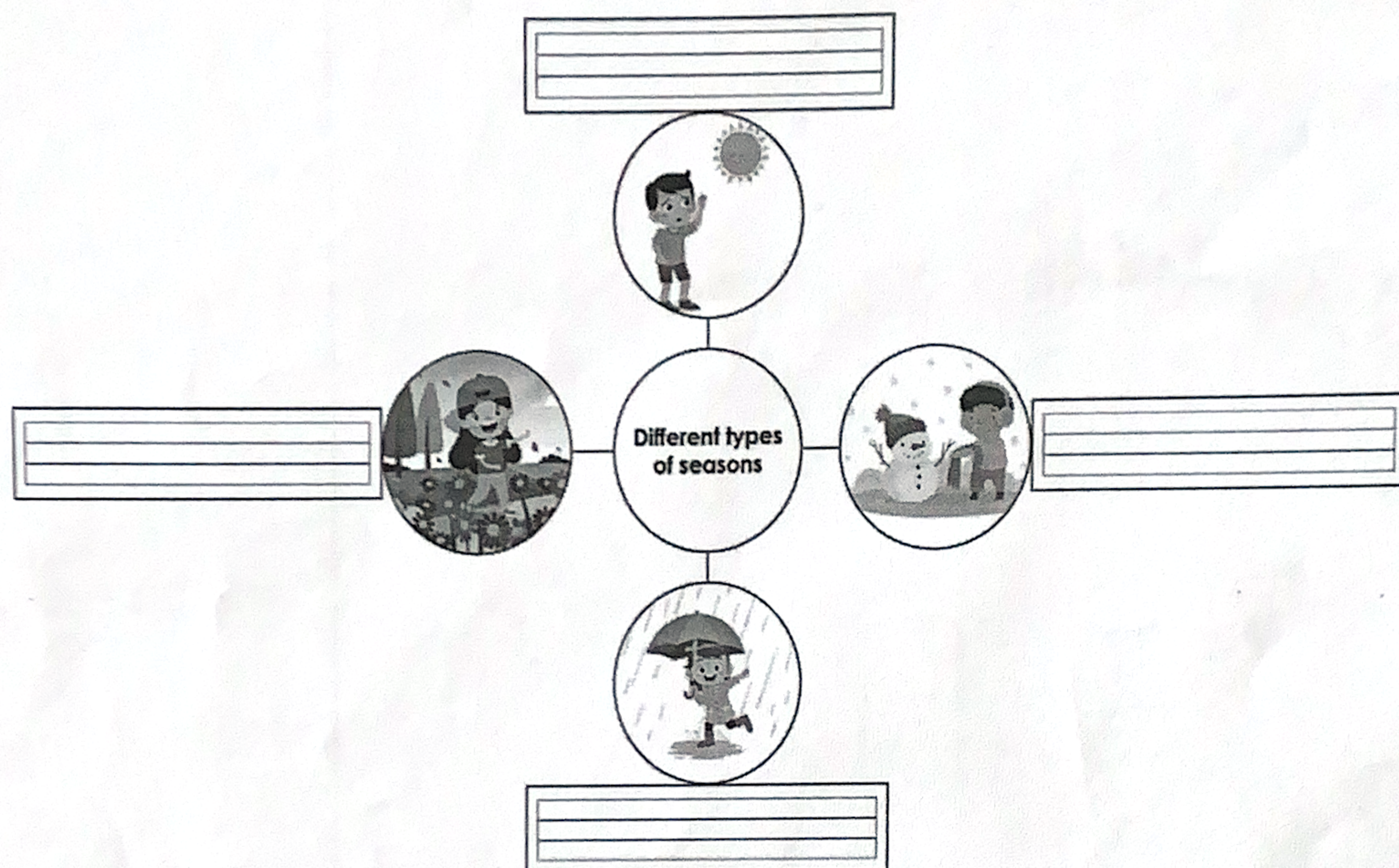

46. Jumbled Words

1 M

1. OHUES-

2. PNOOS-
